

**DELMARVALOUS QUILTERS**  
**BONUS SKILL BUILDER**

**TRIPLE TRIANGLE BLOCK**

Dee Christopher



**Starting note: Measurements are based on a plain square (lower left). That square can be ANY configuration. This month's block is a half-square triangle unit.**

**Establish your square. The numbers will work!**

Starting with the bottom square, determine your finished size and add  $\frac{1}{2}$ " to cut. **Cut 2 squares.**

**Cut 2 rectangles** width of square plus 1".

**Join** as in diagram.

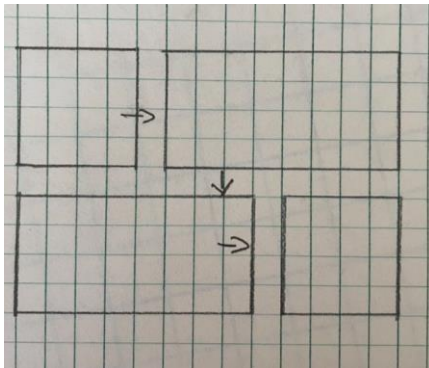

Sew square to rectangle, 2 times. Then sew together.

**Mark before cutting.**

From the back of the block, mark a 45-degree line from the corner, lining up with the square-rectangle intersection.

Be sure to keep your points. You may want to mark just a thread away from the intersection.

**Measure** length and width of unit before cutting.

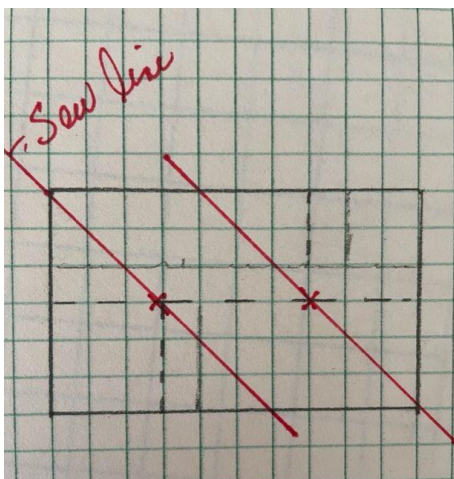

**Cut a rectangle** of that size. Layer together and **sew on both lines.**

Measure  $\frac{1}{4}$ " from sewing line and cut. Do both sides.

2 Triple Triangle Units are formed.

Starting square can be any configuration.

©Pat Hersl  
302-604-8590